

CHAPTER 8

WEIGHT AND BALANCE

<i>Figure</i>	<i>Title</i>	<i>Page</i>
8-1	Ballast Installation	8.0

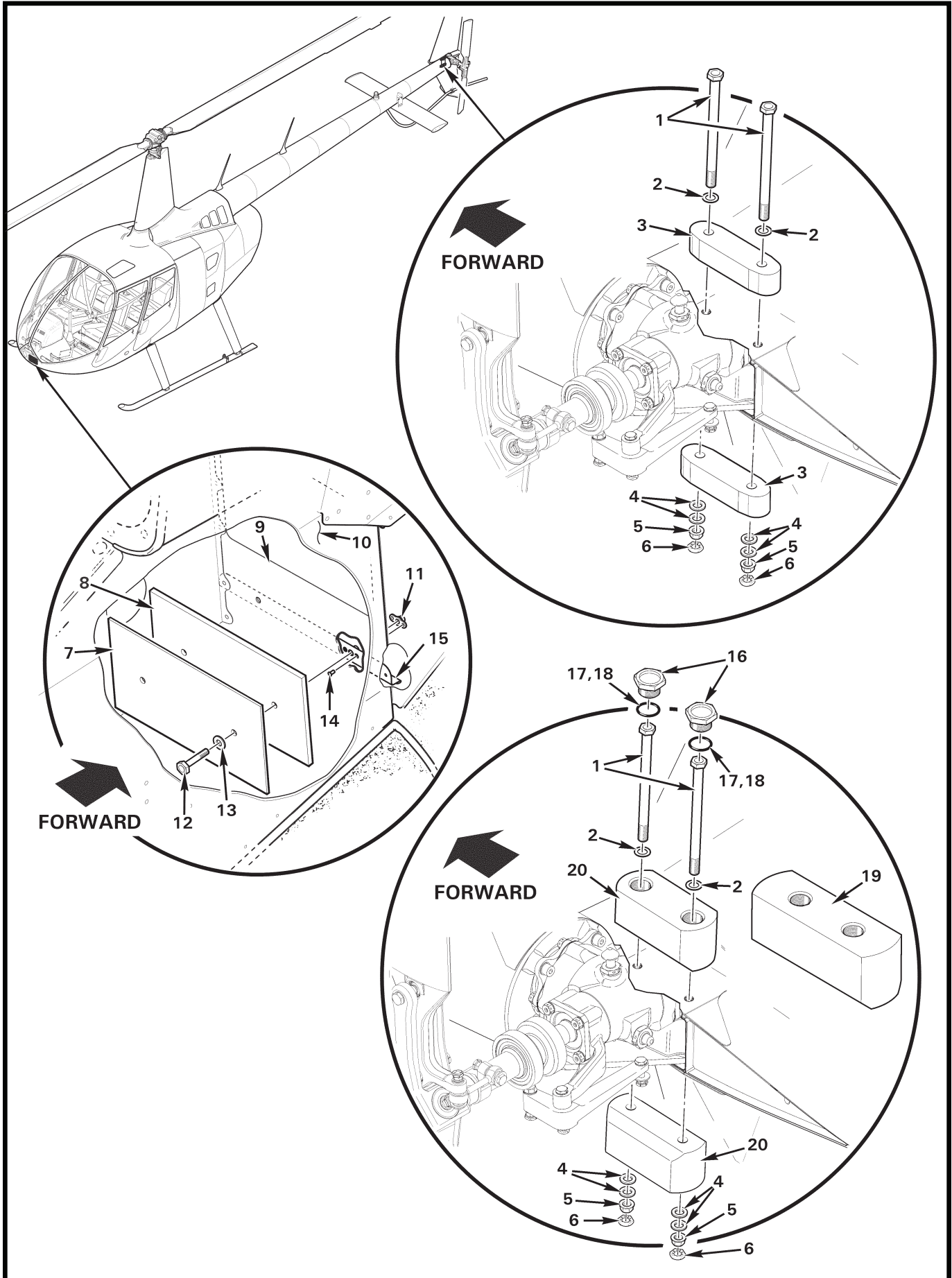

FIGURE AND INDEX NUMBER	PART NUMBER	DESCRIPTION	PARTS AVAIL	QTY PER ASSY
BALLAST INSTALLATION				
8-1-1	NAS6606-78	Bolt (replaces NAS6606-47 Bolt)	X	2
2	NAS1149F0632P	Washer	X	2
3	D301-2*	Weight (1.5 lb; 4.65-in. x 1-in.)	X	A/R
4	NAS1149F0663P	Washer ([1] or [2] under nut as required for 1 to 4 threads exposed)	X	A/R
5	D210-6	Nut	X	2
6	B330-19	Palnut	X	2
7	A941-5**	Ballast Plate (0.25 lb)	X	A/R
8	A941-6**	Ballast Plate (1.25 lb)	X	A/R
9	F361-1	Console Panel (Ref)		
10	F033	Lower Console Assembly (Ref)		
11	MS21069L3	Nutplate (Ref)		
12	NAS6603	Bolt (Select bolt length to meet torque requirements per R66 MM § 20-30 Part E. NAS428-3A14 or shorter with excess threads exposed optional.)	X	2
13	NAS1149F0332P	Washer	X	2
14	NAS1097AD3	Rivet (Ref)		
15	C360-4	Stiffener Assembly (Ref)		
16	AN814-10D	Plug	X	2
17	A215-018	O-ring (install using item 18)	X	2
18	A257-18	Lube – O-ring	X	A/R
19	D301-8*	Weight (10.5 lb; 6.8-in. x 2.75-in.)	X	A/R
20	D301-4*	Weight (4.5 lb; 4.75-in. x 2-in.)	X	A/R
* * *				
21	KI-174	Empennage 3.0 lb Ballast Installation Kit (Includes items 1 thru 6. See https://robinsonheli.com for kit contents and instructions.)	X	A/R

NOTES * Maximum allowable empennage ballast is 9.0 lb (except Police & ENG versions). One upper and one lower weight are required. Available combinations provide total weight of 3, 6, 9, 12, 15, & 21 lb. Refer to R66 MM Chapter 8 to determine fixed ballast requirements.
 ** Maximum allowable nose ballast is 15 lb. Refer to R66 MM Chapter 8 to determine fixed ballast requirements.

Intentionally Blank